



# ***Delta 2000 FO***





## Delta 2000 FO

Key cutting machine for cutting by code  
Ford Tibbe® (FO21P) and Jaguar®  
(TBE1P-TBE2P) type keys

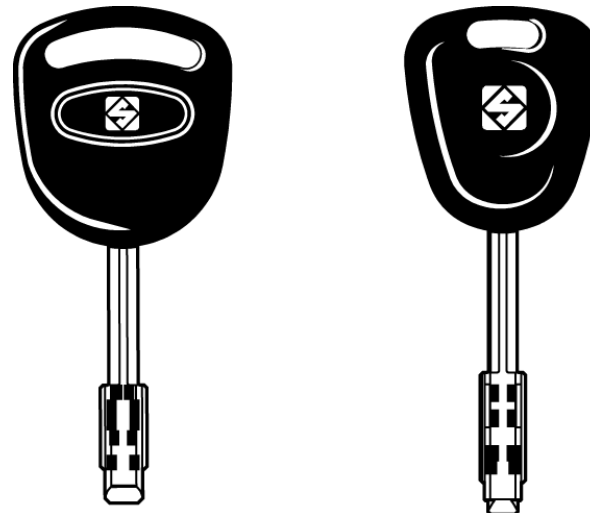



## Delta 2000 FO



- Innovative, small and compact.
- Versatile.
- Easy and intuitive to use
- Conformity to CE standards.



## OPTIONAL

- **"AY" carriage** for a duplication by code of Abloy® type keys.

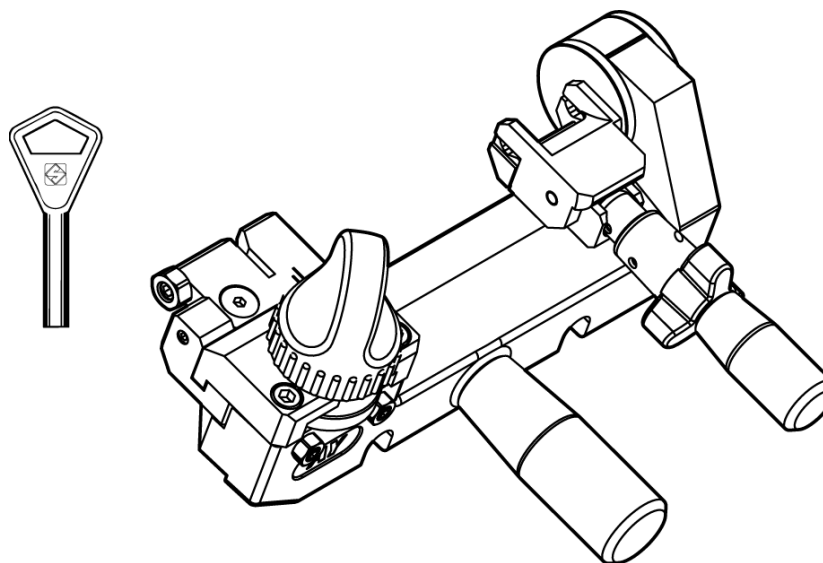



## OPTIONAL

- **"MC" carriage** for a duplication by copy of Ford® (FO19P-FO20P), Abus® (AB32-AB38P) and Abloy® (AY1-AY2-AY11) type keys.

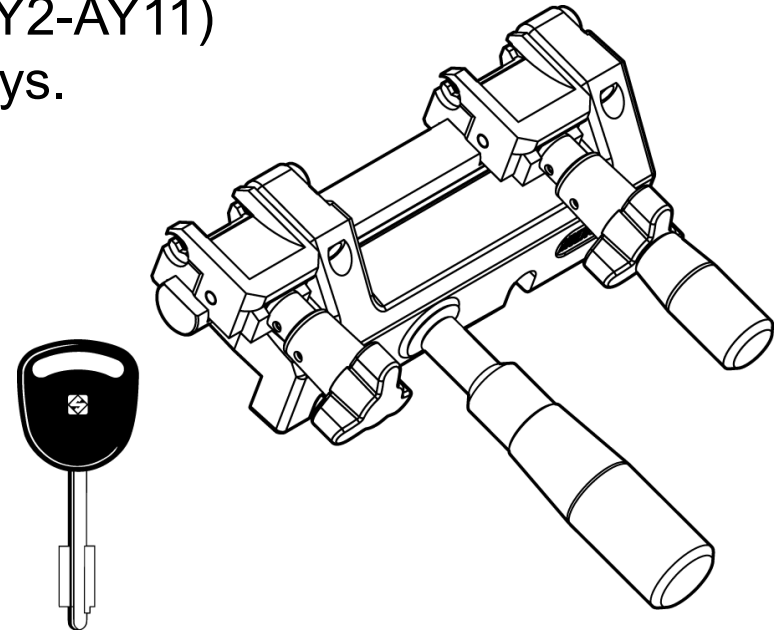



### ***Technical Data***

**Motor:** One speed single phase

**Cutter:** Super Rapid Steel (HSS)

**Clamp:** Tilting

**Dimensions:** width 8,27" (210 mm), depth 14,6" (370 mm), height 9,8" (250 mm)

**Weight:** 14 Kg.



### IMPORTANT

All information and illustrations in this documentation are for guidance only. Silca reserves the right to alter products designs, dimensions or info to improve the products quality. The contents of this documentation are fully protected by Copyright and may not be copied or reproduced in any form, without written permission from Silca. Any infringements will be dealt with under Italian law.

In compliance with current regulations relating to industrial property, we hereby state that the trade-marks or trade names mentioned in our documentation are the exclusive property of authorized manufacturers of locks and users. Said trade-marks or trade names are nominated only for the purposes of information so that any lock for which our keys are made can be rapidly identified. This documentation is reserved exclusively for professional key cutters who use Silca products.